

REDUCING UNION

TRU

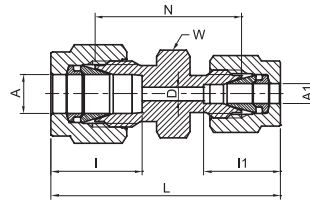

TUBE (METRIC) TO TUBE (METRIC)								
Part Number	A Tube O.D.	A1 Tube O.D.	D	W Hex. flat	N	L	I	I1
	mm	mm	mm	mm	mm	mm	mm	mm
TRU - 3M - 2M	3	2	1.7	12	22.1	35.3	12.9	12.9
TRU - 6M - 2M	6	2	1.7	14	24.6	38.6	15.9	12.9
TRU - 6M - 3M	6	3	2.4	14	24.6	38.6	15.9	12.9
TRU - 6M - 4M	6	4	2.4	14	25.4	39.4	15.9	13.7
TRU - 8M - 6M	8	6	4.8	15	27.4	42.3	16.2	15.3
TRU - 10M - 6M	10	6	4.8	18	29.5	44.5	17.2	15.3
TRU - 10M - 8M	10	8	6.4	18	30.0	45.1	17.2	16.2
TRU - 12M - 6M	12	6	4.8	22	29.5	47.0	22.8	15.3
TRU - 12M - 8M	12	8	6.4	22	30.2	47.8	22.8	16.2
TRU - 12M - 10M	12	10	7.9	22	31.0	48.7	22.8	17.2
TRU - 16M - 10M	16	10	7.9	24	31.8	49.5	24.4	17.2
TRU - 16M - 12M	16	12	9.5	24	31.8	52.0	24.4	22.8
TRU - 18M - 12M	18	12	9.5	27	33.3	53.5	24.4	22.8
TRU - 25M - 18M	25	18	15.1	35	38.6	61.0	31.3	24.4
TRU - 25M - 20M	25	20	15.9	35	39.9	62.3	31.3	26.0

TUBE (METRIC) TO TUBE (INCH)								
Part Number	A Tube O.D.	A1 Tube O.D.	D	W Hex. flat	N	L	I	I1
	mm	in	mm	mm	mm	mm	mm	mm
TRU - 2M - 4	2	1/4	1.7	14	24.0	38.6	12.9	15.3
TRU - 3M - 2	3	1/8	2.4	12	22.1	35.2	12.9	12.7
TRU - 4M - 2	4	1/8	2.4	12	23.4	36.5	13.7	12.7
TRU - 4M - 4	4	1/4	2.4	14	25.4	39.4	13.7	15.3
TRU - 6M - 2	6	1/8	2.4	14	24.6	38.5	15.3	12.7
TRU - 6M - 4	6	1/4	4.8	14	26.2	41.0	15.3	15.3
TRU - 6M - 5	6	5/16	4.8	14	27.4	42.3	15.3	16.2
TRU - 8M - 2	8	1/8	2.4	15	25.9	39.9	16.2	12.7
TRU - 8M - 4	8	1/4	4.8	15	27.4	42.3	16.2	15.3
TRU - 8M - 6	8	3/8	6.4	16	29.5	44.3	16.2	16.9
TRU - 10M - 2	10	1/8	2.4	18	27.1	41.8	17.2	12.7
TRU - 10M - 4	10	1/4	4.8	18	29.5	44.5	17.2	15.3
TRU - 10M - 5	10	5/16	6.4	18	30.0	45.1	17.2	16.2
TRU - 10M - 6	10	3/8	7.1	18	31.0	45.9	17.2	16.9
TRU - 12M - 5	12	5/16	6.4	22	30.2	47.8	22.8	16.2
TRU - 12M - 6	12	3/8	7.1	22	31.0	48.4	22.8	16.9
TRU - 12M - 8	12	1/2	9.5	22	31.0	51.2	22.8	22.9
TRU - 15M - 8	15	1/2	10.3	24	31.8	52.0	24.4	22.9
TRU - 16M - 10	16	5/8	12.7	24	31.8	52.0	24.4	24.4
TRU - 18M - 12	18	3/4	15.1	27	33.3	53.5	24.4	24.5

"D" - Dimension is minimum opening - dimensions are for reference only, and are subject to change without notice.

REDUCING UNION

TRU

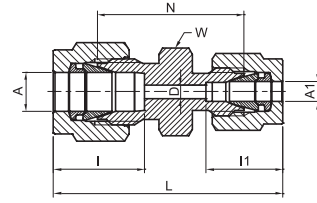

TUBE (INCH) TO TUBE (INCH)																
Part Number	A Tube O.D.		A1 Tube O.D.		D		W Hex. flat		N		L		I		I1	
	in	mm	in	mm	in	mm	in	mm	in	mm	in	mm	in	mm	in	mm
TRU - 2 - 1	1/8	3.17	1/16	1.58	0.05	1.27	7/16	11.1	0.81	20.57	1.22	30.98	0.50	12.7	0.34	8.6
TRU - 3 - 1	3/16	4.76	1/16	1.58	0.05	1.27	7/16	11.1	0.86	21.84	1.27	32.26	0.54	13.7	0.34	8.6
TRU - 3 - 2	3/16	4.76	1/8	3.17	0.09	2.28	7/16	11.1	0.92	23.36	1.44	36.57	0.54	13.7	0.50	12.7
TRU - 4 - 1	1/4	6.35	1/16	1.58	0.05	1.27	1/2	12.7	0.91	23.11	1.35	34.29	0.60	15.3	0.34	8.6
TRU - 4 - 2	1/4	6.35	1/8	3.17	0.09	2.28	1/2	12.7	0.97	24.63	1.52	38.60	0.60	15.3	0.50	12.7
TRU - 4 - 3	1/4	6.35	3/16	4.76	0.12	3.04	1/2	12.7	1.00	25.40	1.55	37.37	0.60	15.3	0.54	13.7
TRU - 5 - 2	5/16	7.93	1/8	3.17	0.09	2.28	9/16	14.3	1.01	25.65	1.56	39.62	0.64	16.3	0.50	12.7
TRU - 5 - 4	5/16	7.93	1/4	6.35	0.19	4.82	9/16	14.3	1.08	27.43	1.66	42.16	0.64	16.3	0.60	15.3
TRU - 6 - 1	3/8	9.52	1/16	1.58	0.05	1.27	5/8	15.9	1.00	25.40	1.44	36.58	0.66	16.9	0.34	8.6
TRU - 6 - 2	3/8	9.52	1/8	3.17	0.09	2.28	5/8	15.9	1.06	26.92	1.61	40.89	0.66	16.9	0.50	12.7
TRU - 6 - 4	3/8	9.52	1/4	6.35	0.19	4.82	5/8	15.9	1.12	28.44	1.70	43.18	0.66	16.9	0.60	15.3
TRU - 6 - 5	3/8	9.52	5/16	7.93	0.25	6.35	5/8	15.9	1.16	29.46	1.74	44.19	0.66	16.9	0.64	16.3
TRU - 8 - 2	1/2	12.70	1/8	3.17	0.09	2.28	13/16	20.6	1.12	28.44	1.78	45.21	0.90	22.9	0.50	12.7
TRU - 8 - 4	1/2	12.70	1/4	6.35	0.19	4.82	13/16	20.6	1.16	29.46	1.85	46.99	0.90	22.9	0.60	15.3
TRU - 8 - 6	1/2	12.70	3/8	9.52	0.28	7.11	13/16	20.6	1.22	30.98	1.91	48.51	0.90	22.9	0.66	16.9
TRU - 10 - 6	5/8	15.87	3/8	9.52	0.28	7.11	15/16	23.8	1.25	31.75	1.94	49.27	0.96	24.4	0.66	16.9
TRU - 10 - 8	5/8	15.87	1/2	12.70	0.41	10.41	15/16	23.8	1.25	31.75	2.05	52.07	0.96	24.4	0.90	22.9
TRU - 12 - 4	3/4	19.05	1/4	6.35	0.19	4.82	1-1/16	27.0	1.25	31.75	1.94	49.28	0.96	24.5	0.60	15.3
TRU - 12 - 6	3/4	19.05	3/8	9.52	0.28	7.11	1-1/16	27.0	1.31	33.27	2.00	50.80	0.96	24.5	0.66	16.9
TRU - 12 - 8	3/4	19.05	1/2	12.70	0.41	10.41	1-1/16	27.0	1.31	33.27	2.11	53.59	0.96	24.5	0.90	22.9
TRU - 12 - 10	3/4	19.05	5/8	15.87	0.50	12.70	1-1/16	27.0	1.31	33.27	2.11	53.59	0.96	24.5	0.96	24.4
TRU - 16 - 8	1	25.40	1/2	12.70	0.41	10.41	1-3/8	34.9	1.59	40.38	2.38	60.45	1.23	31.2	0.90	22.9
TRU - 16 - 12	1	25.40	3/4	19.05	0.62	15.75	1-3/8	34.9	1.59	40.38	2.38	60.45	1.23	31.2	0.96	24.5

"D" - Dimension is minimum opening - dimensions are for reference only, and are subject to change without notice.